

## This lever will fit 35mm to 45mm door thickness

### LEVER SET INSTALLATION INSTRUCTIONS AND TEMPLATE

#### Detailed scheme parts

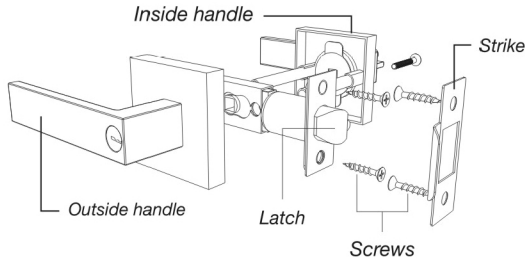

#### Tools needed

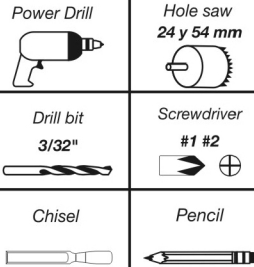

#### Determining door handling

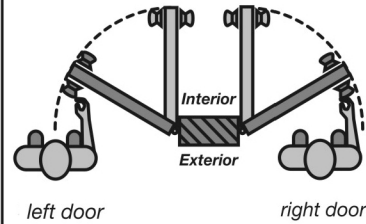

Door handling is determined by standing outside the place/room and looking where the hinges are placed. If they are placed on the right side the door is right and left if the hinges are placed on the left side.

#### Door preparations

##### HOLE MARKING

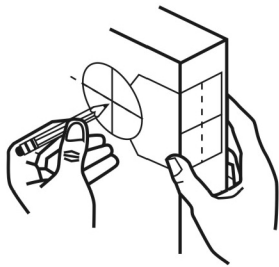

Place the template and fold on the door edge, check the distances and centers to drill. Select the distance from the edge of the door. It is recommended to install 90 to 100 cm regarding of floor.

1

##### HOLES

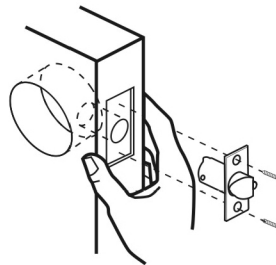

Carefully punch the door with a drill on the previously marked centers, doing first the larger diameter to 54mm (2 1/8") and then the center of the edge of the door of 24mm (15/16").

2

#### Latch preparation

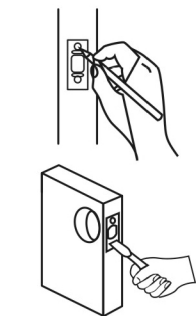

Insert the bolt into the hole 24 mm and draw the outline of the front, slot with the chisel all this area to 3 mm depth of where the latch plate will lodge.

3

#### Setting latch

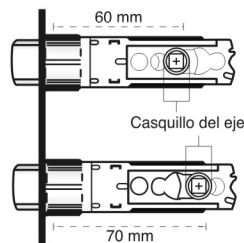

Adjust the latch to the distance you are going to install, 60 or 70 mm (Backset 2 3/8" or 2 3/4").

4

#### Latch installation

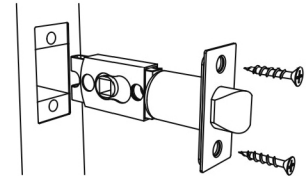

Insert the latch into the hole in the door edge with its sloping side according to the direction that go to close the door. Screw the mechanism on the door edge until the plate flush with the surface.

5

#### Fixing of exterior handle lock

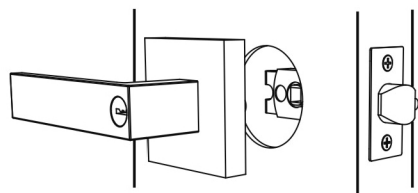

Install the lock of exterior handle by inserting the posts and the square bolt into the holes on the latch mechanism.

6

#### Installation of interior handle lock

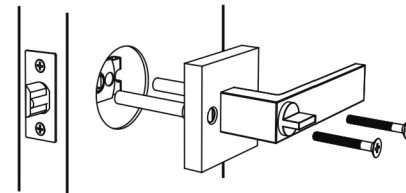

Install the interior handle lock connecting it to the square bolt of the outer part and positioning the screws from the interior latch toward the posts. Screw and try the operation.

7

#### Strike installation

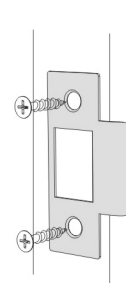

Install " the plate - against " in the frame of door using the height of the latch to do the needed perforations.

8

# Template

